



Shanghai Minyue
Semiconductors Co.,Ltd
Tel:0086-21-57159233
Fax:0086-21-60415325

BAS70WT THRU BAS70WT-06

200mW Schottky Barrier Rectifiers 70 Volts

Features

- Low Turn-on Voltage
- Fast Switching
- Ultra-Small Surface Mount Package
- Forward Continuous Current: 70mA @ Ta= 25°C
- Operating Temperature Range Tj: -55 to +125°C
- Storage Temperature Range Tstg: -65 to +150°C

Mechanical Data

- Epoxy meets UL 94 V-0 flammability rating
- Moisture Sensitivity Level 1
- Marking Code: BAS70WT=K73
BAS70WT-04=K74
BAS70WT-05=K75
BAS70WT-06=K76

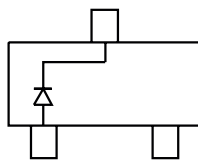

BAS70WT

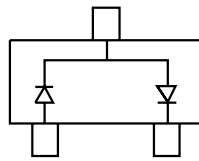

BAS70WT-04

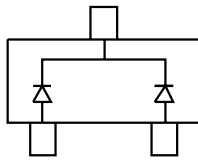

BAS70WT-05

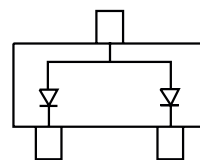

BAS70WT-06

SOT-323

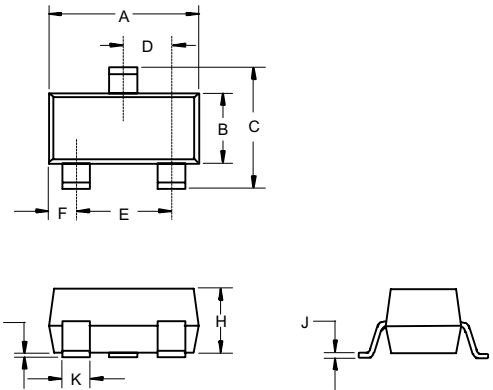

DIM	INCHES		MM		NOTE
	MIN	MAX	MIN	MAX	
A	.071	.087	1.80	2.20	
B	.045	.053	1.15	1.35	
C	.079	.087	2.00	2.20	
D	.026 Nominal		0.65Nominal		
E	.047	.055	1.20	1.40	
F	.012	.016	.30	.40	
G	.000	.004	.000	.100	
H	.035	.039	.90	1.00	
J	.004	.010	.100	.250	
K	.012	.016	.30	.40	

Electrical Characteristics @ 25°C Unless Otherwise Specified

Symbol	Parameter	Min	Typ	Max	Units
$V_{(BR)R}$	Reverse Breakdown Voltage ($I_R=10\mu A$)	70	---	---	V
V_F	Forward Voltage $I_F=1.0mA$ $I_F=15mA$	---	---	410 1000	mV
I_R	Leakage Current ($V_R=50V$)	---	---	100	nA
C_D	Junction Capacitance ($V_R=0$, $f=1.0MHz$)	---	---	2.0	pF
t_{rr}	Reverse Recovery Time ($I_F=10mA$ through $I_R=10mA$ to $I_R=1.0mA$)	---	---	5.0	ns

Suggested Solder Pad Layout

